

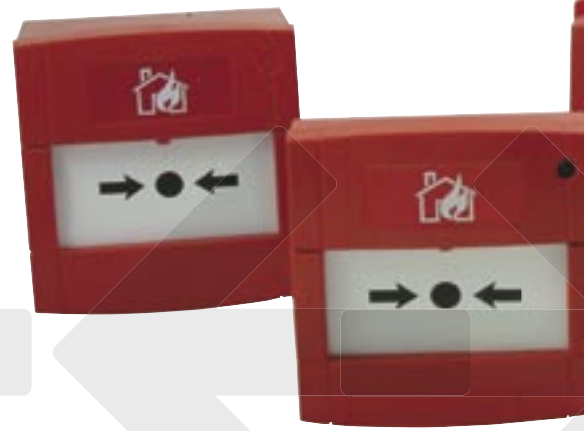

MANUAL CALL POINTS



- > From conventional to analogue addressable, from indoor to outdoor, from surface-mounted to flush-mounted and from red to yellow, green, blue and white in colour, our range offers you unparalleled choice.

MEETING THE NEEDS OF THE OEM

The MCP range enables third party original equipment manufacturers to fully integrate their electronics into the call point housing. This can encompass full design and layout of electronic interfaces, component sourcing and assembly through to final test and shipping. The package also extends to bespoke branding and packaging to suit individual requirements. Smoke detector, panel and systems manufacturers can all benefit.



FAST AND EASY INSTALLATION

A new patented 'plug and play' concept is at the heart of this new design, which utilises a special terminal block.

Upon initial installation, cabling can be terminated into the terminal block. The terminal block is then fitted with a simple continuity link, enabling the wiring of the fire alarm system to be tested for open, short circuit and earth fault without the manual call point unit itself in place. Therefore, the MCP product does not need to be fitted until the final commissioning stage. This is extremely advantageous; because full installation before commissioning on a site where other services are still being installed can increase the likelihood of damage.

Upon final commissioning, the continuity link is removed from the 'plug and play' terminal block, which is then plugged directly into the back of the MCP. Simple but effective: no re-termination required, no time wasted. The call point is now electrically installed; the call point body is screwed to the back box, the break glass or re-settable element is placed in position and secured. Installation complete.

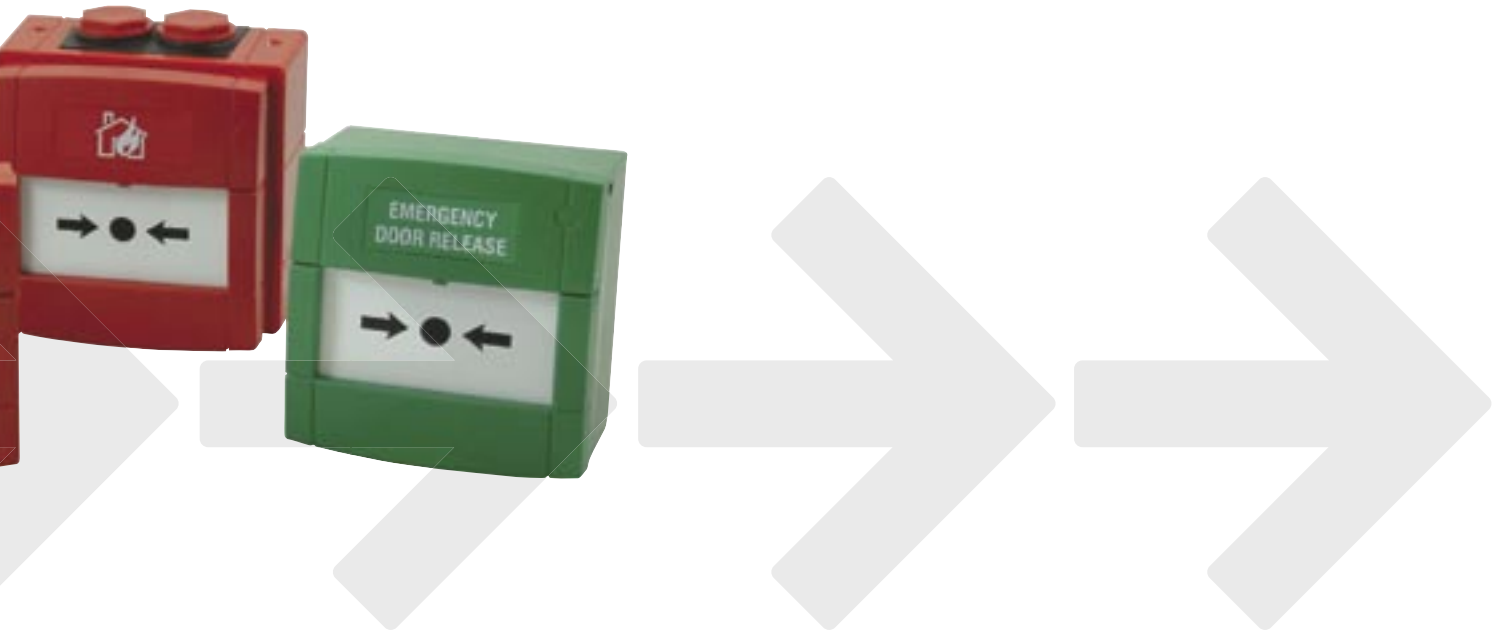

SIMPLE MAINTENANCE PROCEDURES

The combined test, reset and lid-release mechanism means only one tool is needed for maintenance. The unique nature of this tool also makes the new generation of MCPs tamper-proof. If the lid of a device is removed without being isolated from the panel, the alarm will sound.

So if the worst should ever come to the worst, there's no chance of suddenly discovering when it's too late that an MCP has been disabled through accident or vandalism.

EN54 COMPLIANT ACROSS THE RANGE

The new generation of call points are EN54 compliant in any format. What's more, the MCP design is ready to meet specifications for both break-glass and resettable call point options.

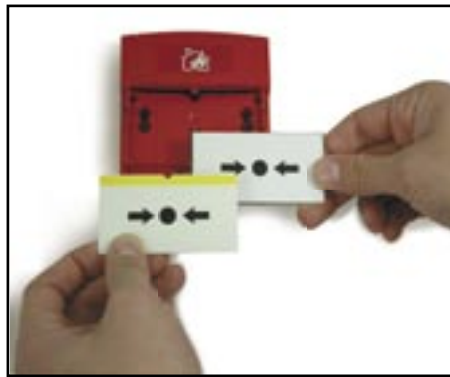

QUICK CHANGE

An MCP break glass can quickly become an EN54-11 resettable MCP. And a resettable MCP can easily be converted back to break glass. With the new design it only takes a change of operating element. The solution is simple and low cost. So much easier than changing the product or adding springs and additional parts.



SWITCHES AND ACCESSORIES

KAC call point switching devices provide alternative methods of manual activation of systems rather than the traditional break-glass principle. They're available in the classic KAC housings, are equally as brandable and, along with our MCPs, are supported by a wide range of accessories including mounting aides that enable easy installation throughout the world.



Lloyds Register
Marine Approved
versions available

